

SCANNED

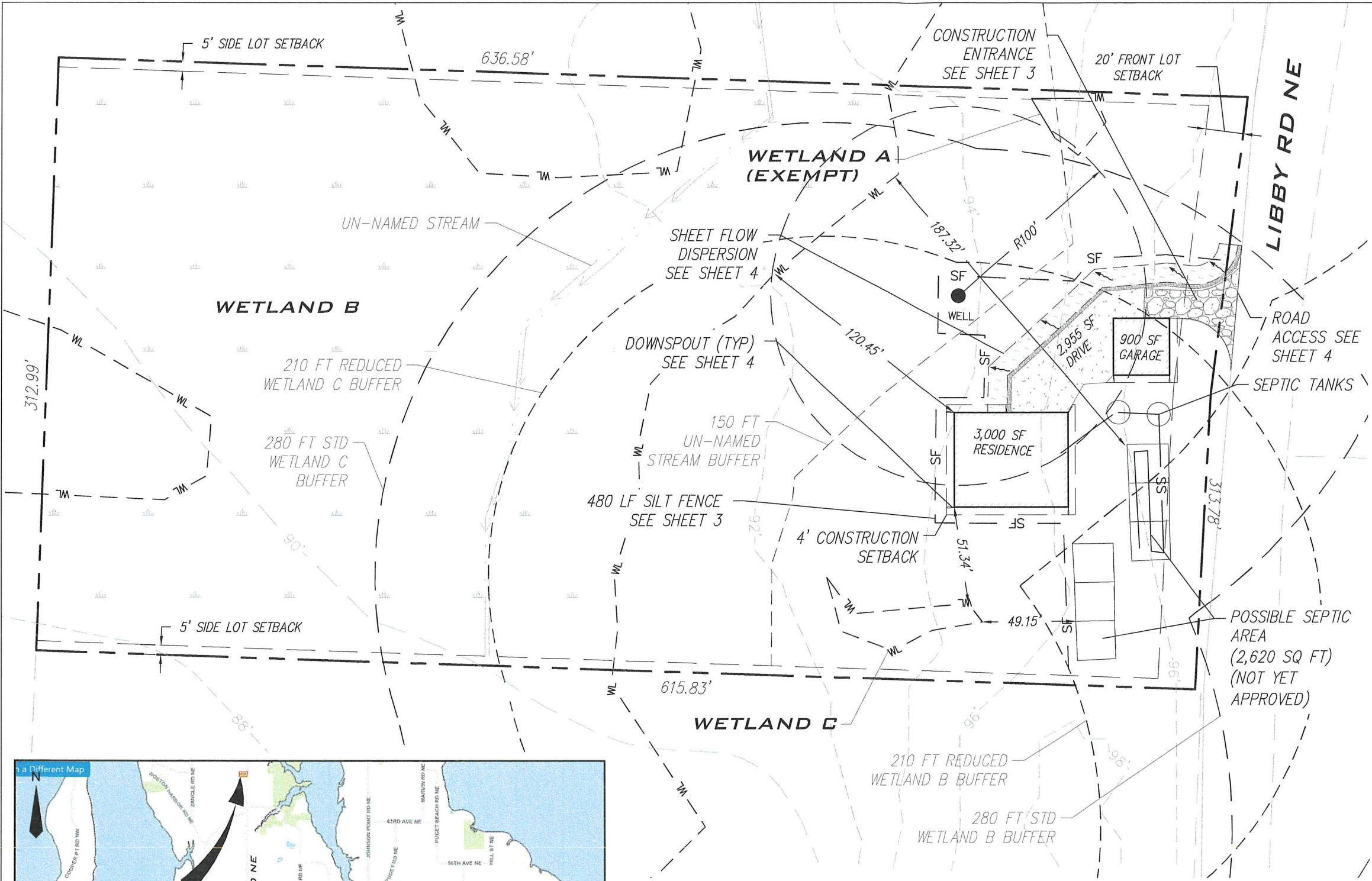

CONTACT INFO

APPLICANT/OWNER:
IRISH, TREVOR J
4402 HENDERSON BLVD SE 101
OLYMPIA, WA 98501

PROJECT INFO

PARCEL #12913140200
7125 LIBBY RD NE
OLYMPIA, WA 98506

198,634 SF LOT AREA (4.56 AC)

ZONING:
RRR 1/5

LEGAL DESCRIPTION:
SECTION 13 TOWNSHIP 19 RANGE 2W SE-SE-NE
LESS S 315F LESS N 30F LESS CO RD

NOTES:

1. CONTOURS AND PROPERTY BOUNDARIES SHOWN ARE NOT FIELD SURVEYED.
2. ALL DISTURBED AREAS DURING CONSTRUCTION WILL HAVE TOP SOIL STOCKPILED AND PLACED BACK. SEE NOTES ON SHEET 2.

PROPOSED HARDSCAPE AREAS:

PROPOSED HOUSE	3,000 SF
PROPOSED GARAGE	900 SF
PROPOSED DRIVEWAY	2,955 SF

HARDSCAPE TOTAL = 6,855 SF

GROUND COVERAGE TABLE

PROPERTY TOTAL AREA	198,634 SF (4.56 AC)
TOTAL HARDSCAPE	6,855 SF *3.5%

* PER ZONING REQUIREMENTS, TOTAL HARDSCAPE SHALL NOT EXCEED 10% OF TOTAL PARCEL AREA

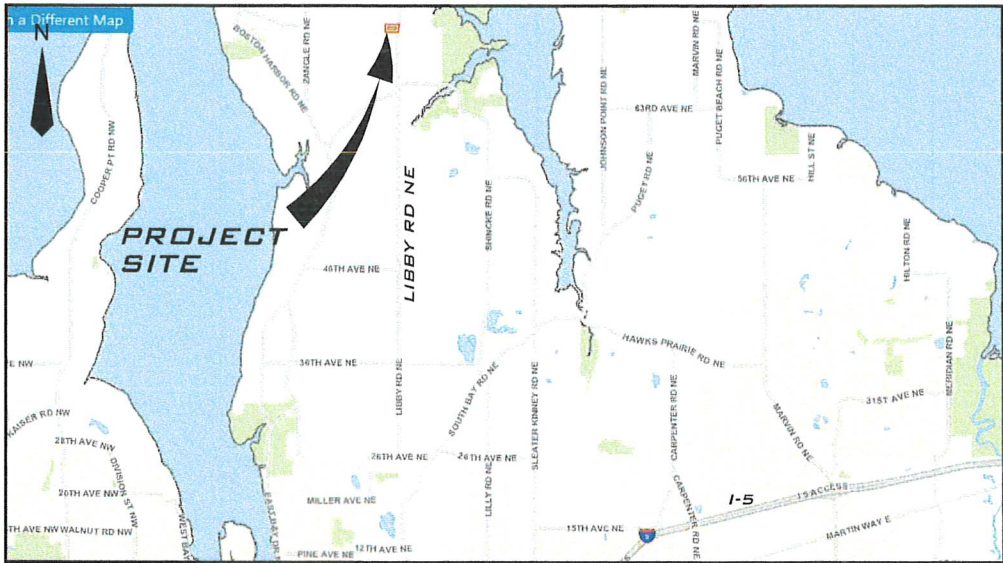

VICINITY MAP

NTS



8/31/23

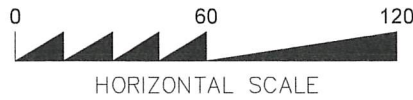

Civil Engineering & Planning

8270 28th Court NE,
Suite 201, Lacey, WA 98516
Phone : 360.459.1102

DWN. BY SDS	DATE 8/31/23	JOB NO. 23527
CHKD. BY CMC	SCALE AS NOTED	SHEET 1 OF 4

IRISH
7125 LIBBY RD NE
OLYMPIA, WA 98506

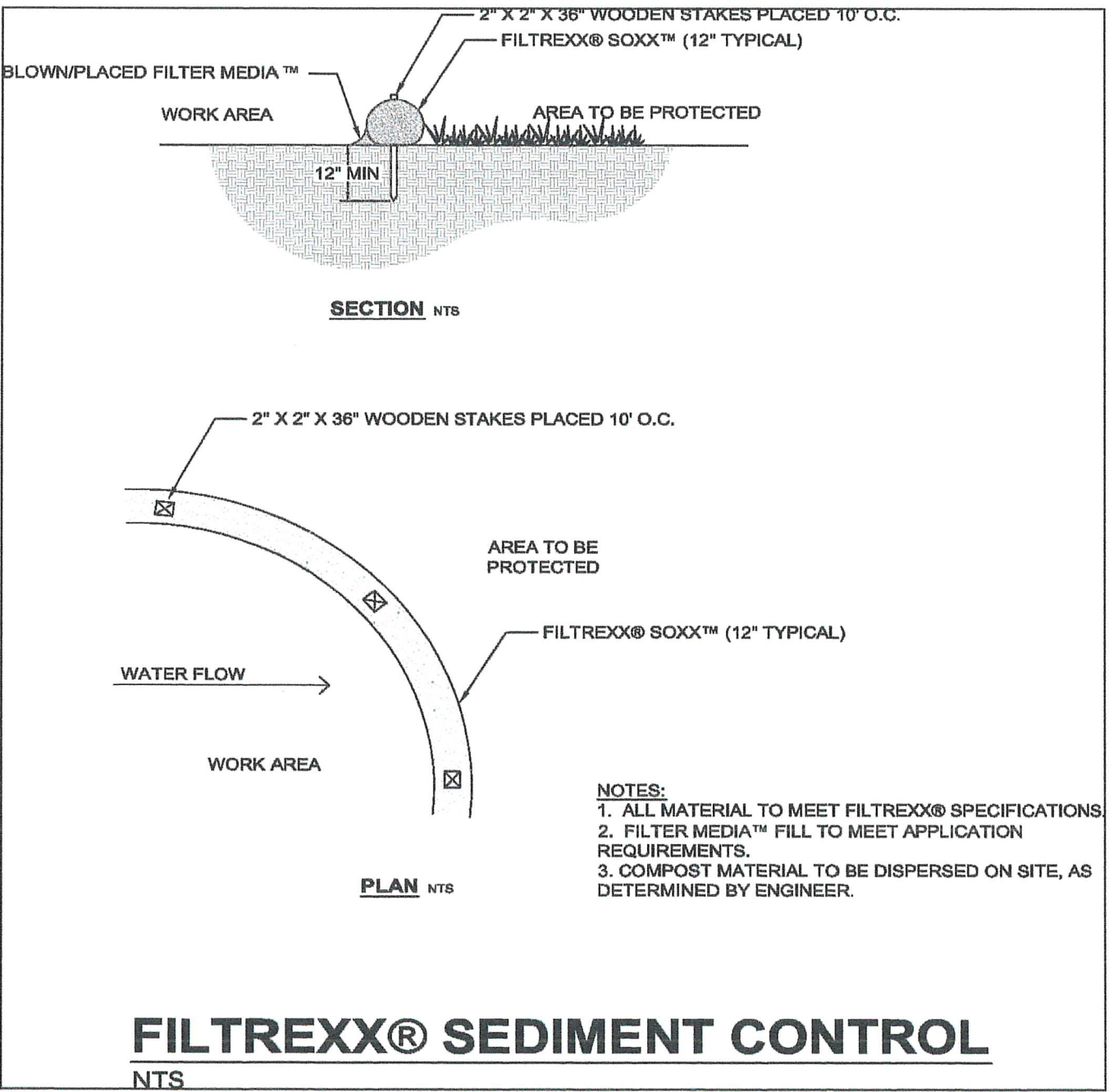

SOIL NOTES:

1. CLEARING WILL BE LIMITED TO AREAS NECESSARY FOR CONSTRUCTION. OPTION 3 (STOCKPILE) IS SUGGESTED TO BE UTILIZED BELOW FOR THIS PROJECT.

2. ANY EXPOSED AREAS AFTER CONSTRUCTION WILL COMPLY WITH THE FOLLOWING LID 02 POST CONSTRUCTION SOIL QUALITY AND DEPTH.

3. ANY COMPOST TO AMEND THE SOILS WILL COME FROM GREAT WESTERN SUPPLY OR LOCAL SUPPLIER. APPROXIMATE AREA IS UP TO 27,825 SF CONSTRUCTION DISTURBANCE TO EXISTING GRASS AREA. EXACT AREA WILL BE DETERMINED IN THE FIELD.

2.1.2 LID.02 POST-CONSTRUCTION SOIL QUALITY AND DEPTH

2.1.2.5.2 SOIL QUALITY

ALL AREAS SUBJECT TO CLEARING AND GRADING THAT HAVE NOT BEEN COVERED BY IMPERVIOUS SURFACE, INCORPORATED INTO A DRAINAGE FACILITY OR ENGINEERED AS STRUCTURAL FILL OR SLOPE SHALL, AT PROJECT COMPLETION, DEMONSTRATE THE FOLLOWING:

A TOPSOIL LAYER MEETING THESE REQUIREMENTS:

- TURF AREAS: PLACE 1.75 INCHES OF COMPOST AND TILL IN TO AN 8 INCH DEPTH. ACHIEVE ANORGANIC MATTER CONTENT, AS MEASURED BY THE LOSS-ON-IGNITION TEST, OF A MINIMUM 4 PERCENT (TARGET 5 PERCENT) ORGANIC MATTER CONTENT. SEE NOTE 1
- PLANTING BEDS: PLACE 3 INCHES OF COMPOST AND TILL IN TO AN 8 INCH DEPTH. ACHIEVE AN ORGANIC MATTER CONTENT, AS MEASURED BY THE LOSS-ON-IGNITION TEST, OF A MINIMUM 8 PERCENT (TARGET 10 PERCENT) DRY WEIGHT. SEE NOTE 1

NOTE 1: ACCEPTABLE TEST METHODS FOR DETERMINING LOSS-ON-IGNITION SOIL ORGANIC MATTER INCLUDE THE MOST CURRENT VERSION OF ASTM D2974 "TEST METHODS FOR MOISTURE, ASH, AND ORGANIC MATTER OF PEAT AND OTHER ORGANIC SOILS" AND TMECC05.07A "LOSS-ON-IGNITION ORGANIC MATTER METHOD"

- A PH FROM 6.0 TO 8.0 OR MATCHING THE PH OF THE ORIGINAL UNDISTURBED SOIL.
- A MINIMUM DEPTH OF 8 INCHES.

ROOT ZONES WHERE TREE ROOTS LIMIT THE DEPTH OF INCORPORATION OF AMENDMENTS ARE EXEMPTED FROM THIS REQUIREMENT. FENCE AND PROTECT THESE ROOT ZONES FROM STRIPPING OF SOIL, GRADING, OR COMPACTION TO THE MAXIMUM EXTENT PRACTICAL.

SCARIFY (LOOSEN) SUBSOILS BELOW THE TOPSOIL LAYER AT LEAST 4 INCHES FOR A FINISHED MINIMUM DEPTH OF 12 INCHES OF UNCOMPACTED SOIL. INCORPORATE SOME OF THE UPPER MATERIAL TO AVOID STRATIFIED LAYERS, WHERE FEASIBLE. PLANTING BEDS MUST BE MULCHED WITH 2 TO 4 INCHES OF ORGANIC MATERIAL SUCH AS ARBORIST WOOD CHIPS, BARK, SHREDDED LEAVES, COMPOST, ETC. DO NOT USE FINE BARK BECAUSE IT CAN SEAL THE SOIL SURFACE.

FOR TURF INSTALLATIONS: WATER OR ROLL TO COMPACT TO 85 PERCENT OF MAXIMUM. DRY DENSITY, RAKE TO LEVEL, AND REMOVE SURFACE WOODY DEBRIS AND ROCKS LARGER THAN 1 INCH IN DIAMETER. (BUILDING SOIL MANUAL [STENN ET AL. 2012] OR WEB SITE <WWW.BUILDINGSOIL.ORG>).

THE RESULTING SOIL SHOULD BE CONDUCIVE TO THE TYPE OF VEGETATION TO BE ESTABLISHED

2.1.2.5.4 IMPLEMENTATION OPTIONS

THE SOIL QUALITY DESIGN GUIDELINES LISTED ABOVE CAN BE MET BY USING ONE OF THE METHODS LISTED BELOW WHICH ARE DESCRIBED IN DETAIL IN THE SOILS FOR SALMON GUIDANCE DOCUMENT (SEE DESIGN GUIDELINES ABOVE):

OPTION 1. LEAVE UNDISTURBED NATIVE VEGETATION AND SOIL, AND PROTECT FROM COMPACTION DURING CONSTRUCTION. IDENTIFY AREAS OF THE SITE THAT WILL NOT BE STRIPPED, LOGGED, GRADED OR DRIVEN ON, AND FENCE THESE AREAS TO PREVENT IMPACTS DURING CONSTRUCTION (SEE BMPS C101, C100, AND C103 IN VOLUME II). IF NEITHER SOILS NOR VEGETATION ARE DISTURBED, THESE AREAS DO NOT REQUIRE AMENDMENT.

OPTION 2. AMEND EXISTING SITE TOPSOIL OR SUBSOIL IN PLACE AT DEFAULT "PREAPPROVED" RATES, OR AT CUSTOM CALCULATED RATES BASED ON TESTS OF THE SOIL AND AMENDMENT. SCARIFY OR TILL THE SUBGRADE TO A DEPTH OF 8 INCHES (OR DEPTH NEEDED TO ACHIEVE A TOTAL DEPTH OF 12 INCHES OF UNCOMPACTED SOIL AFTER CALCULATED AMOUNT OF AMENDMENTS ARE ADDED). AMEND SOIL TO MEET REQUIRED ORGANIC CONTENT DEPENDENT ON THE USE (PLANTING AREA OR TURF SEE FIGURE 2.1) AND WHETHER THE PRE-APPROVED OR CALCULATED RATE METHOD IS USED.

OPTION 3. STOCKPILE EXISTING TOPSOIL DURING GRADING, AND REPLACE IT PRIOR TO PLANTING. STOCKPILED TOPSOIL MUST ALSO BE AMENDED IF NEEDED TO MEET THE ORGANIC MATTER OR DEPTH REQUIREMENTS, EITHER AT A DEFAULT "PRE-APPROVED" RATE OR AT A CUSTOM CALCULATED RATE. IF PLACED TOPSOIL PLUS COMPOST OR OTHER ORGANIC MATERIAL WILL AMOUNT TO LESS THAN 12 INCHES, THEN THE SUBGRADE WILL BE SCARIFIED OR TILLED TO ACHIEVE 12 INCHES OF LOOSENED SOIL AFTER AMENDMENT. REPLACE STOCKPILED TOPSOIL PRIOR TO PLANTING. AMEND STOCKPILED TOPSOIL IF NEEDED TO MEET REQUIRED ORGANIC CONTENT DEPENDENT ON THE USE (PLANTING AREA OR TURF) AND WHETHER THE PREAPPROVED OR CALCULATED RATE METHOD IS USED.

OPTION 4. IMPORT TOPSOIL MIX OF SUFFICIENT ORGANIC CONTENT AND DEPTH TO MEET THE REQUIREMENTS. SCARIFY OR TILL SUBGRADE IN TWO DIRECTIONS TO 6 INCHES DEPTH.

IMPORTED SOILS SHOULD NOT CONTAIN EXCESSIVE CLAY OR SILT FINES (MORE THAN 5 PERCENT PASSING THE US #200 SIEVE) BECAUSE THAT COULD RESTRICT STORMWATER INFILTRATION. USE TOPSOIL MIX SUITABLE FOR PROPOSED USE (PLANTING BED OR TURF AREA). PLACE TOPSOIL IN LAYERS PER RECOMMENDATIONS OF SOILS FOR SALMON GUIDANCE DOCUMENTS (SEE DESIGN GUIDELINES ABOVE).



8/31/23



Civil Engineering & Planning

8270 28th Court NE,
Suite 201, Lacey, WA 98516
Phone : 360.459.1102

DWN. BY
SDS

CHKD. BY
CMC

DATE
8/31/23

SCALE
AS NOTED

JOB NO.
23527

SHEET
2 OF 4

IRISH
7125 LIBBY RD NE
OLYMPIA, WA 98506

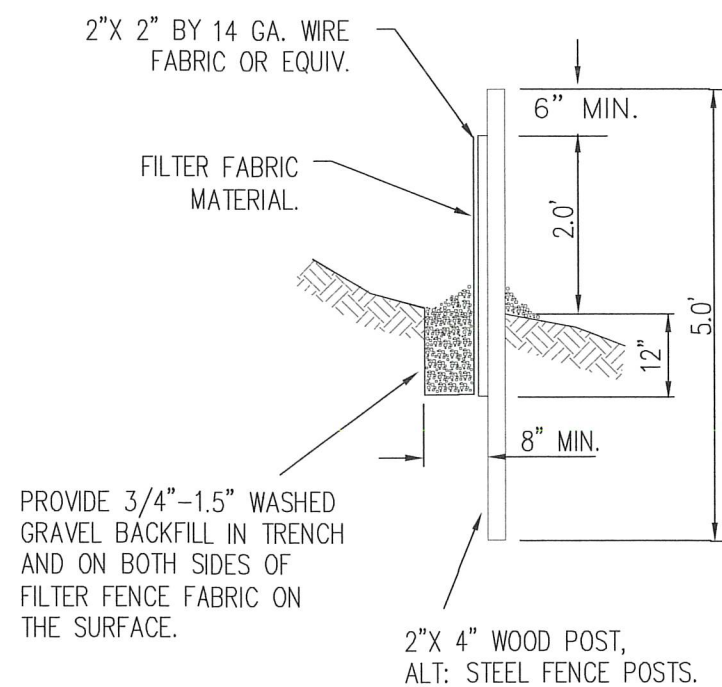

NTS

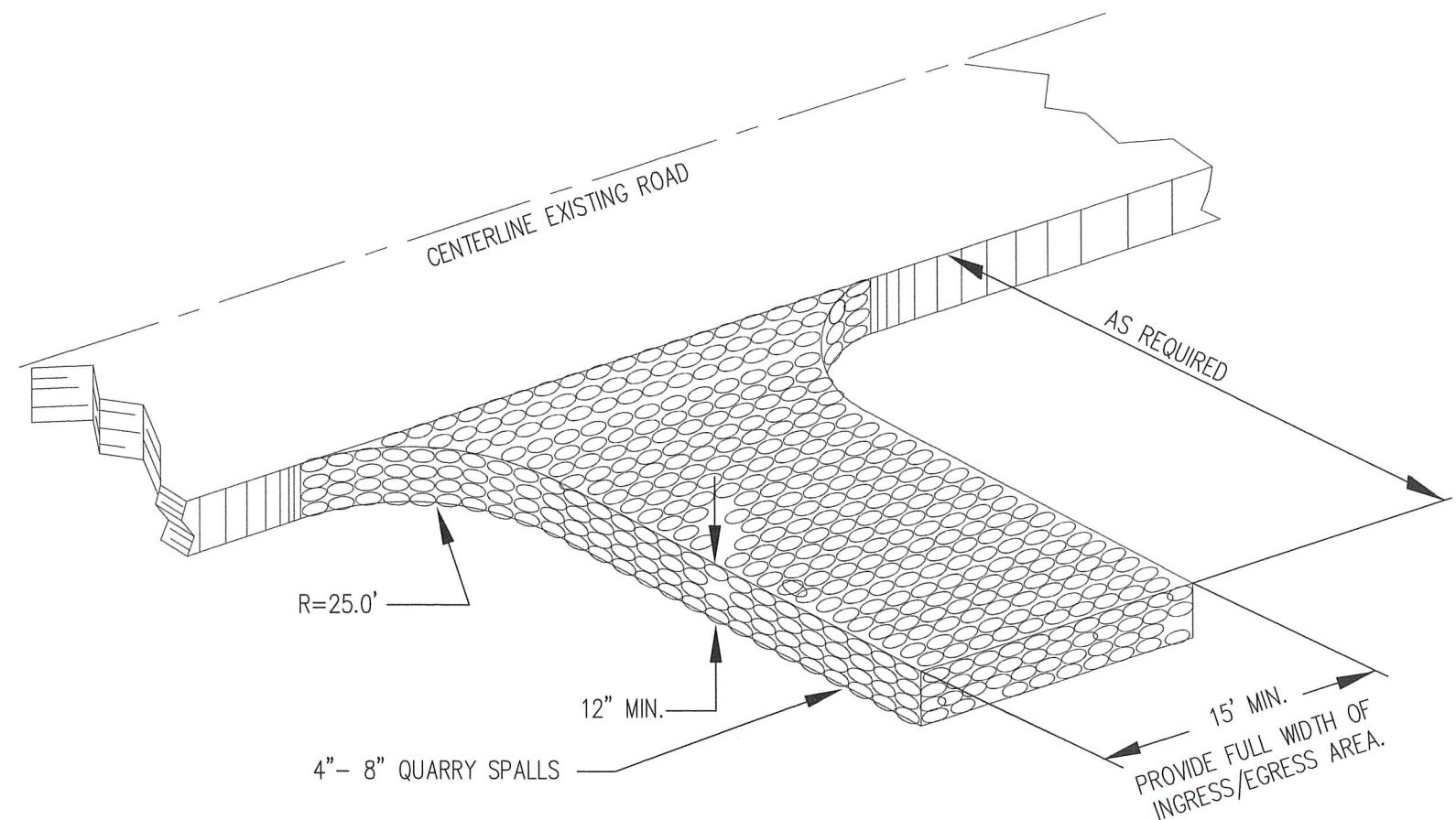

NTS



8/31/23



SHEET
3 OF 4

IRISH
7125 LIBBY RD NE
OLYMPIA, WA 98506

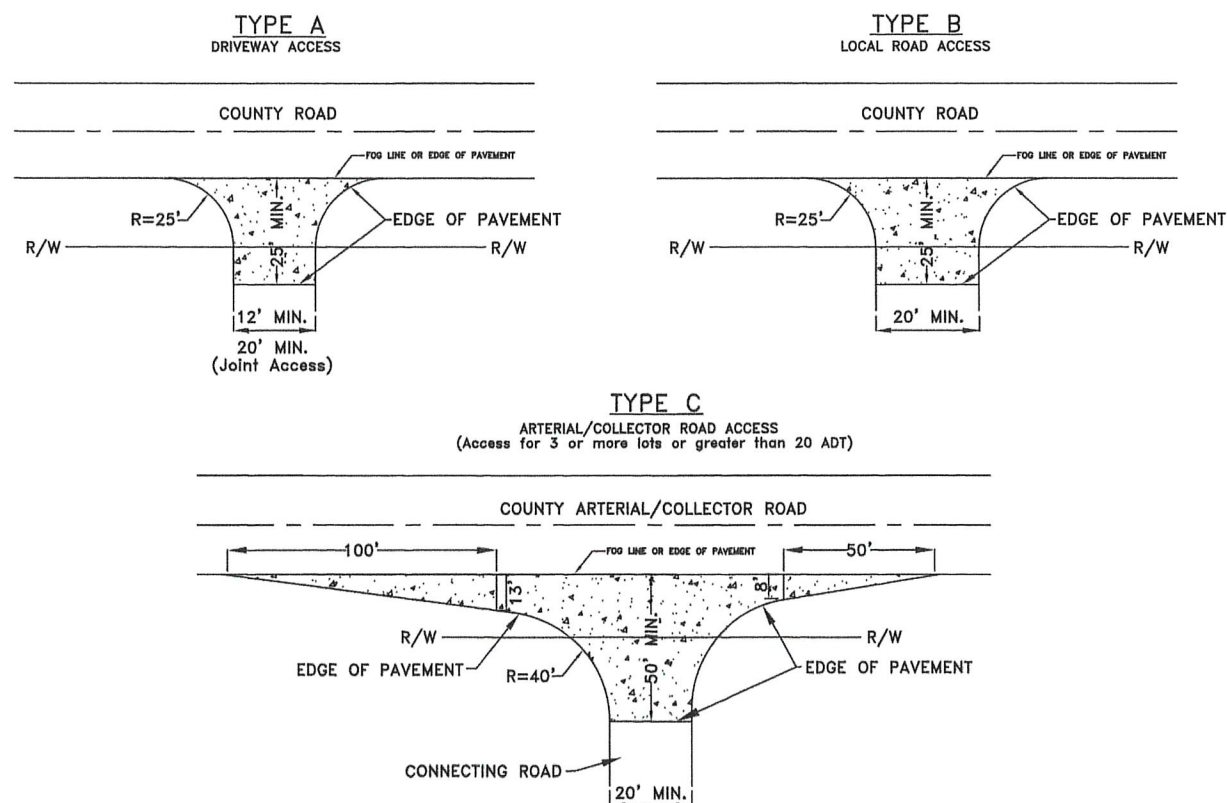

- ### GENERAL NOTES

- | | |
|---|--|
| <p>1. ALL APPROACHES SHALL BE INSTALLED WITH A STRUCTURAL CROSS SECTION THAT MATCHES THE SECTION OF THE CONNECTING DRIVEWAY/ROAD. GRAVEL DRIVEWAY/ROAD APPROACHES SHALL BE PAVED (2" MIN. ASPHALT, 6" MIN. CONCRETE).</p> <p>2. ALL APPROACHES ARE SYMMETRIC ABOUT CENTERLINE UNLESS OTHERWISE NOTED.</p> | <p>3. WHERE LARGER TRUCK TURNING MOVEMENTS ARE ENCOUNTERED, LARGER RETURN RADII AND RIGHT TURN TAPERS MAY BE REQUIRED. RADIIUS AND TAPERS SHALL BE DETERMINED BY THE COUNTY ENGINEER.</p> <p>4. WHERE REQUIRED, CULVERTS SHALL BE IN ACCORDANCE WITH APPENDIX 7-B.</p> |
|---|--|

O:\DESIGN\Engineering\Manuals, Standards, Guidelines\Road Standards Drawings\ROADSTD

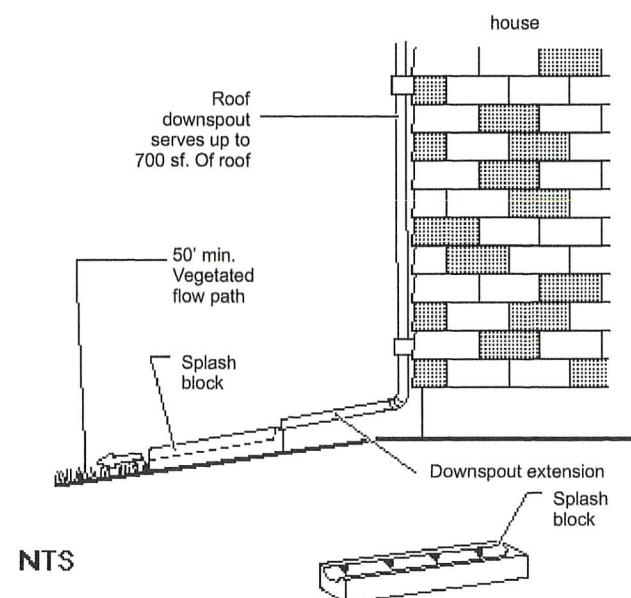

Figure V - 2.8 Typical Downspout Splash block Dispersion

LAST REVISED	12/2018



THURSTON COUNTY
PUBLIC WORKS

DEVELOPMENT
REVIEW

ROADWAY STANDARDS

COUNTY ROAD ACCESSES

APPENDIX 7 - A

Figure V-3.2: Sheet Flow Dispersion for Driveways

Source: King County Department of Natural Resources, 1998

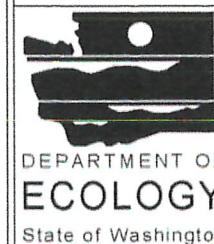
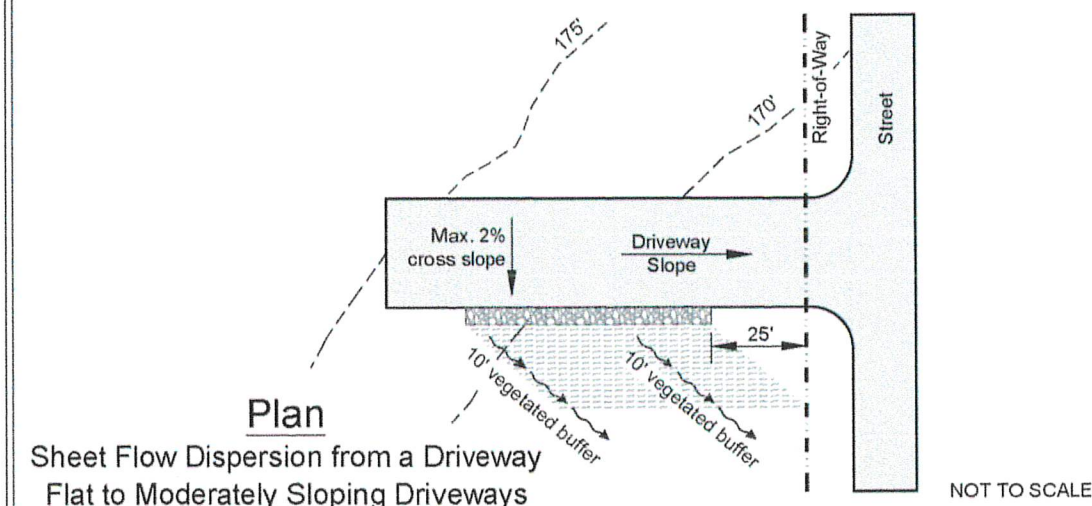
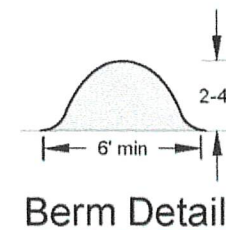
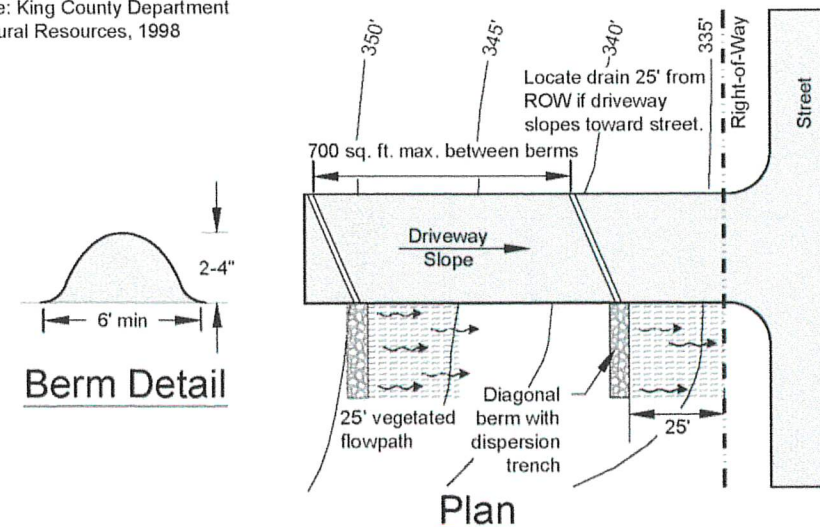

Sheet Flow Dispersion for Driveways

Revised December 2016

Please see <http://www.ecy.wa.gov/copyright.html> for copyright notice including permissions, limitation of liability, and disclaimer.

IRISH
7125 LIBBY RD NE
OLYMPIA, WA 98506



8/31/23



Civil Engineering & Planning

8270 28th Court NE,
Suite 201, Lacey, WA 98516
Phone : 360.459.1102

DWN. BY	SDS
---------	-----

DATE
8/31/23

JOB NO.
23527

CHKD. BY	
CMC	

SCALE
AS NOTED

SHEET
4 OF 4